

Electric Scooter Infinity User Manual

Thanks for choosing us. To make your E-Scooter up and start enjoying an exciting experience,
please read this manual carefully.



WE ADVISE YOU TO READ THIS MANUAL CAREFULLY BEFORE USING YOUR E-SCOOTER

Contents

1 General safety instructions	3
2 Battery safety instructions	4
3 Safe use of battery charger	4
4 Vehicle technical information	5~6
5 Instructions for use	6~9
6 Package Contents	10
7 Vehicle fault code and troubleshooting	10~11

General safety instructions

- › This is a product, not a toy. When driving an electric scooter, you should wear protective equipment (helmet, hand, elbow and knee protection devices).
- › Do not remove your hands from the handlebars and do not use the phone while driving.
- › Do not make dangerous moves or drive with one hand, and place your feet on the scooter.
- › Before using your electric scooter, make sure you understand the local regulations. Such vehicles cannot drive on narrow sidewalks.
- › Only one person can ride an electric scooter. The law prohibits more than one person from riding the same electric scooter at the same time.
- › Only use original brand accessories. Unauthorized modification is strictly prohibited.
- › Do not disassemble your electric scooter at will.
- › The higher the speed of the electric scooter, the greater the braking distance. On some smooth roads, emergency braking can cause the scooter to slip, lose its balance or even fall. Therefore, when driving a scooter, you must stay alert, drive at an appropriate speed, and keep a safe distance from pedestrians or other vehicles
- › When walking on a scooter, avoid rapid acceleration/deceleration and lean acceleration.

- › Do not use your electric scooter in heavy rain, and do not use it in a puddle of more than 4 cm, there is a danger of the motor being immersed in water; avoid extreme temperature use.
- › Do not bring the electric scooter near the fire.
- › When the electric scooter is driving fast, don't try to jump on or off; don't use the electric scooter to play extreme sports.
- › Do not hang heavy objects on the handlebars.
- › Before each use, thoroughly check the entire device, such as whether the locking screws of the motor, front wheels, folding joints, etc. are fastened and reliable. Do not drive at will before correcting any problems.
- › Any electric scooter that does not work properly may be dangerous.
- › Do not try to jump over curbstones/highlands more than 3 cm away, as this may cause damage to the driver or the scooter.
- › We recommend that you do not use electric scooters on rough roads and ground, as this will increase the possibility of tire damage.
- › Do not charge or use this product outdoors in an environment below -5° C.
- › Pregnant women, the disabled, and those with heart problems should not use this product
- › An electric scooter is a way to move independently. Our technology and production process are developed and verified through very strict testing.
- › If you do not operate the electric scooter according to the instructions in this manual, it may damage the product or cause personal injury.

Battery safety instructions

- › The battery should not be exposed to excessive heat, such as sunlight, near a fire or similar high temperature environment. There is a danger of explosion.
- › If it is not used for more than 30 days, it should be fully charged and stored.
- › If it is not used for a long time, the battery should be fully charged every 90 days. Otherwise, the battery will discharge by itself and be damaged.
- › If the battery emits a strong odor or emits heat, stop using the product immediately. Do not open the product shell without authorization, let alone try to disassemble the battery.
- › Batteries should be disposed of properly and safely.

Safe use of battery charger

- › The charger is not suitable for children and people with mental disorders.
- › Before use, carefully check whether the power plug and cable are damaged.
- › You must use a charger that matches the product to charge. The charger cannot be abused.

- › The product must be charged in a well-ventilated environment. After the battery is fully charged, disconnect the charger from the power supply immediately.
- › Before cleaning, storage and transportation, disconnect the battery from the charger and allow it to cool down.
- › Do not connect the damaged product to the charger to avoid electric shock.
- › Protect the charger and other electrical components from moisture. When cleaning or using, do not soak them in liquid.
- › Do not disassemble the charger privately. Repairs must be carried out by professional and reliable personnel. Incorrect assembly may cause fire or electric shock.
- › Do not place the charger near flammable and explosive materials. There is a risk of fire and explosion.
- › When using the charger, please make sure that the charger and the charging port are well connected, correct and not blocked by foreign objects.
- › Be sure to place the power cord where no one will fall, step on, or damage it. So as not to cause harm to people or things.
- › Do not charge near flammable and explosive materials

Vehicle technical information

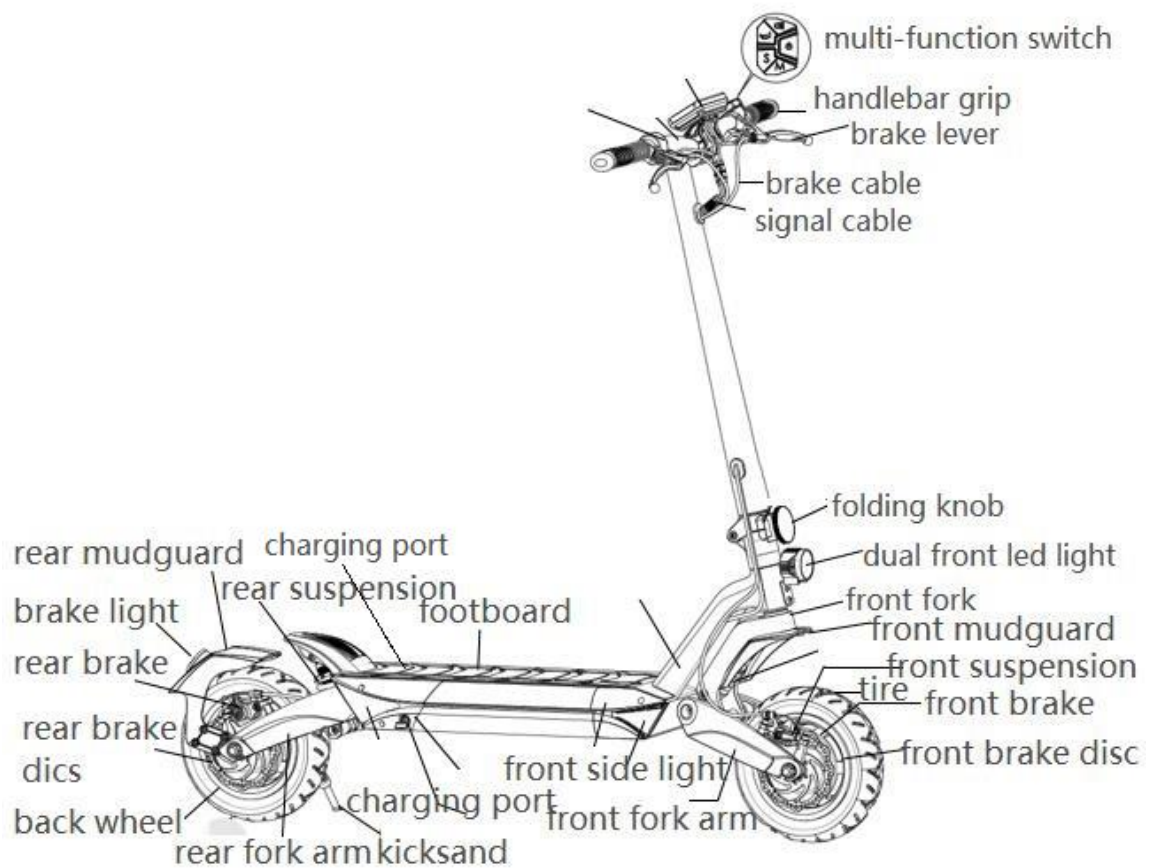

Whole-vehicle

The Project	Content	Parameters
Vehicle parameters	Unfolded dimensions	1295X670X1185mm
	Folded dimensions	1295X670X550mm
	Net weight	26.5Kg
	Max speed	40Km/h
	Range age	55-60Km
	Climbing ability	20% degrees
	Adapto the terrain	Both city and country are available
	Operating temperature	-10~40 degrees
	Storage temperature	-20~40 degrees
	Waterproof rating	IPX4
	Charging time	5-6 hours

Battery parameters	Rated voltage	48V
	Rated capacity	20Ah
Motor parameters	Wheel size	10 inches
	Tire type	Off road tubeless tire
	Rated voltage	48V
	Rated power	1000W
	Motor type	Brushless DC motor
Brake	Brake braking mode	Front and rear mechanical disc brake + electric brake
Charger	Input the voltage	100V~240V
	Output voltage	54.6V
	Output current	2A
	Maximum load	150KG

Instructions for use

Use the operating steps for the first time

This section provides information about how to use the product correctly. Following these instructions is necessary for the safety of the user and the service life of the product.

1. Insert the handlebars assembly at the fold large tube and lock the 4 screws.
2. Close the fold plug, buckle the lock, and twist the lock.

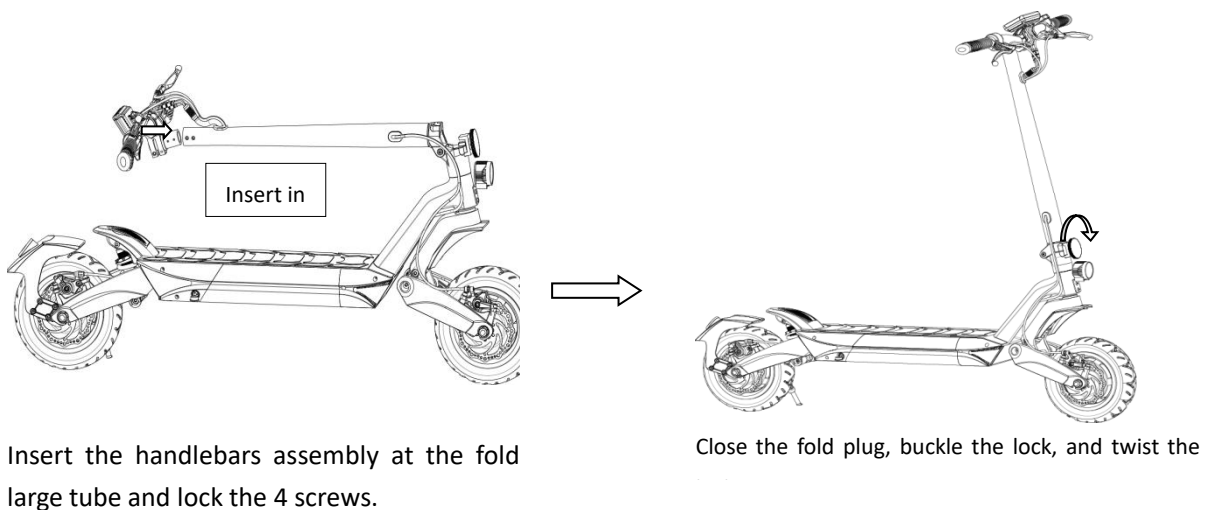



Power ON/OFF button: Long press 3S to power on. Long press 3S to power off.

Light switch: short click the light switch to on/off

Klaxon: Hold the switch to Klaxon alarm

Speed "+": click the speed switch "+" button to increase speed

Speed "-": click the speed switch "-" button to reduce speed

Mode setting: switch from KM/H to MPH

Display indicator instruction

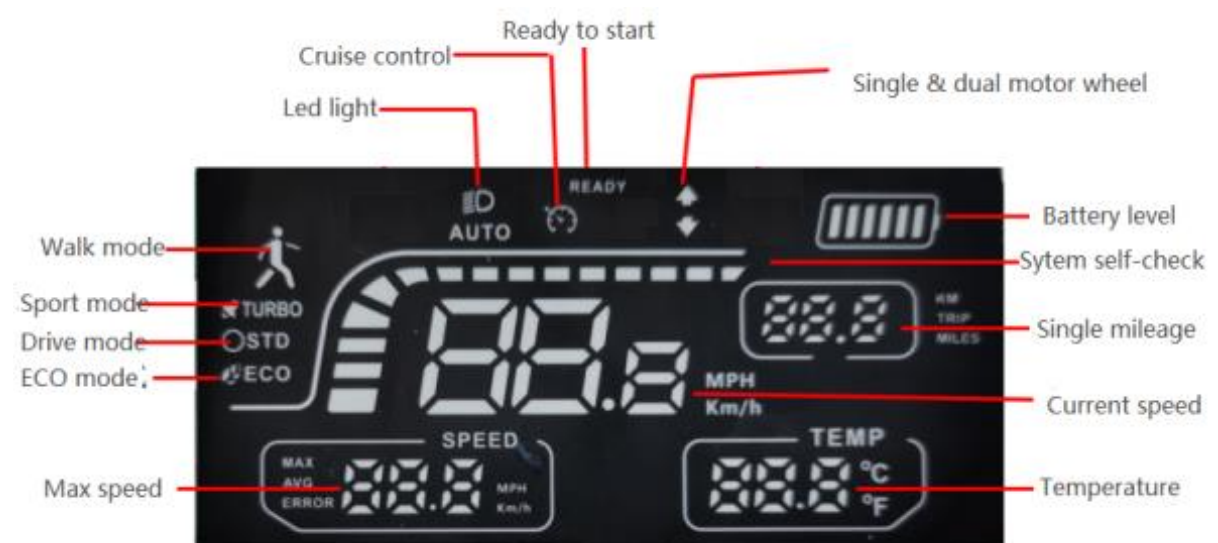

Power display: Six led lights on the display show battery power.

When 6 led s charge between 100% and 90%, and when 5 led s light up, power between 90% and 70%. When the battery runs out, five led lights turn off (one on, red warning) and the scooter slides to a natural stop due to inertia. So you have to charge it very soon. It is recommended not to drain the battery by 100% and charge it before use.



Double-drive mode: T8 double-drive, double-click the headlight switch button of the multi-function switch,



the instrument display shows, at this time the vehicle is dual-drive mode.

When READY: turns on, the word "READY" appears on the instrument display to remind riders to wear a helmet and sheath and abide by traffic regulations when riding.

Cruise at cruise speed: turn on the cruise speed function, you can release the acceleration handle, the vehicle walks at a uniform speed. After the brake stops, press the acceleration bar again, and the vehicle returns to the initial state.



Next Light: After the vehicle is powered on, press the headlight switch button for clicking the multi-function switch. Symbols appear on the instrument display, when all the lights of the vehicle are turned on.



Pedestrian mode: symbols on the instrument display when the vehicle speed is less than 6Km/h.

Maximum speed: It shows the highest speed of the whole ride.

Current speed: The display shows the current speed during cycling

Single mileage: Show the current mileage during the ride, and automatically return to zero after turning off the power supply.

Riding operation

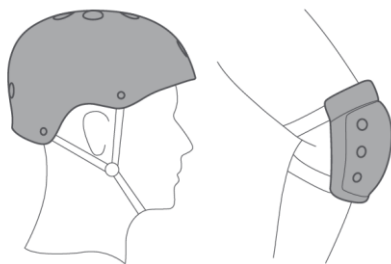

Wear your helmet and sheath before riding to avoid falling and getting hurt.

- 1、 Press the power switch and turn on the vehicle power supply to confirm that the power is sufficient.
- 2、 Standing on one foot on deck, press the acceleration finger to let the car go, and put the other foot on deck.

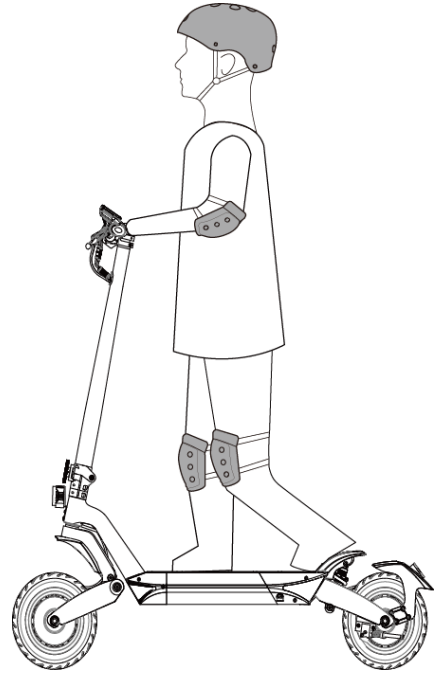
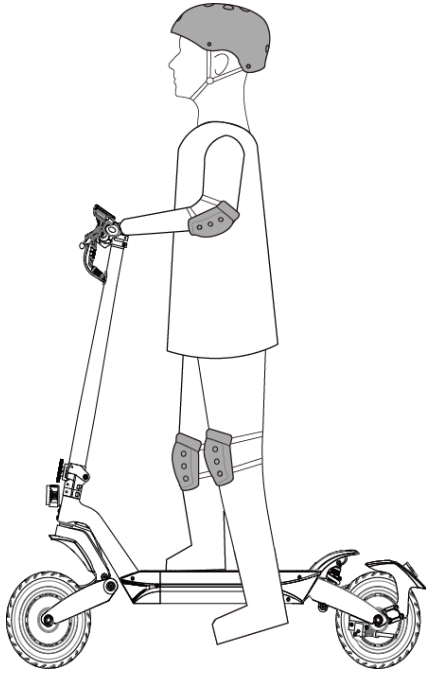

3、 Press the acceleration refers to the acceleration, upward release is deceleration, encounter emergency need to brake, brake rear brake, rear brake front brake, or at the same time, emergency brake, do not only brake the front brake.

4、 When turning, please slow down and turn the handlebars slowly.

Refold the scooter:

- 1、 Turn the fold connector knob counterclockwise until the fold connector buckle no longer holds the connector;
- 2、 Fold the handlebars and tubes to the rear.

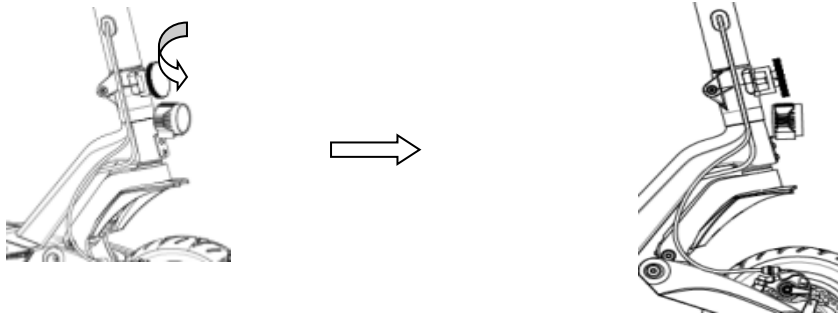

Package contents:

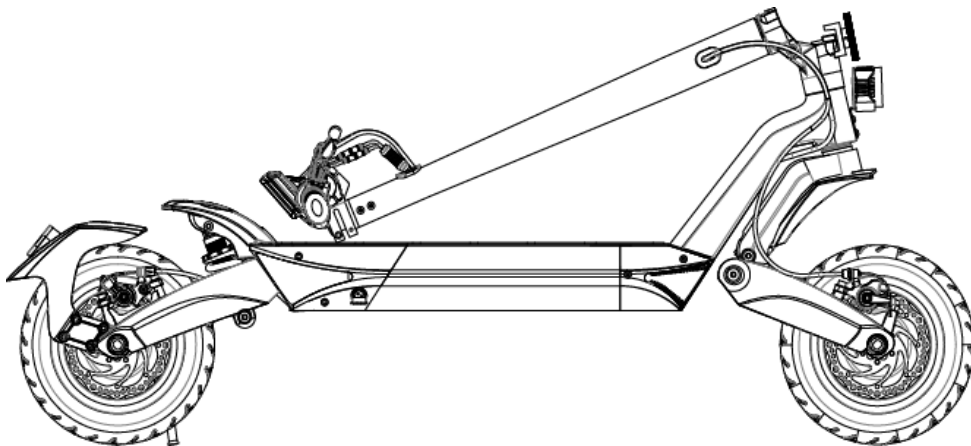

Annex



x4



x1

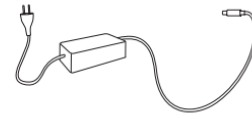

x1

Packaging including: 1 x Scooter, 4 x M5*P0.8 screws, 1 x 15 # internal hexagon wrench, 1 x charger

Error code and troubleshooting:

Error code and troubleshooting		
Error code	Failure description	Maintenance and treatment
4	Short-circuit fault	Check if there is a wrong wire connection or if there is a short circuit in the installation, remove the short circuit or replace the controller
9	Secondary motor communication has failed	Check whether the connection line between the secondary controller and the main controller is well connected.
10	Dashboard communication has failed	Check whether the instrument panel and controller assembly cables are normal, turn off, remove the assembly line interface, check the plug-in for slanting and loosening, and insert again after processing. Power on, replace instrument or controller.
11	Motor current sensor is abnormal	Check the motor and the phase line portion of the controller
14	Accelerator Hall exception	Check whether the accelerator is completely reset, check whether the accelerator and connection line are normal, can disconnect the acceleration connection line, and restart to exclude exceptions.
15	The brakes put Hall abnormal	Check whether the brake handle is completely reset, can pull out the electronic brake cable, restart,

		troubleshooting.
16	Motor Hall exception	Start-up fault, check whether the motor Hall wiring is normal, shut-off, pull out the assembly line interface and check whether the plug-in is crooked, or bad contact, correct, restart and troubleshooting
19	Secondary motor Hall exception	Check the secondary motor Hall wiring for normal, check the replacement motor or controller to eliminate problems
21	The BMS communication is abnormal	
50	Bus line high voltage	The voltage of the main line is too high, and the fault is turned on. You should check whether the battery voltage is normal and faulty during cycling. You should replace the battery or controller to eliminate the problem
53	System overload	Beyond the system load, restart, start up failure, the controller should be replaced to eliminate the problem
55	Controller high temperature alarm	The controller temperature is too high, static let the car to cool and then restart. If the startup fails, replace the controller to eliminate the problem.